

PSk2-60 C-SJ75-12

Solar Submersible Pump System for 8" wells

System Overview

Head	max. 200 m
Flow rate	max. 109 m³/h

Technical Data

Controller PSk2-60

- High efficiency solar pump controller
- Inputs for water meter, pressure sensors, digital switches
- Simple configuration with LORENTZ PumpScanner Android™ App
- Onboard data logging and system monitoring
- Inbuilt applications for constant pressure, constant flow and daily amount
 - Integrated Sun Sensor
- Active temperature management
- Integrated MPPT (Maximum Power Point Tracking)

Power	max. 58 kW
Input voltage	max. 850 V
Optimum Vmp**	> 575 V
Motor current	max. 95 A
Efficiency	max. 98 %
Ambient temp.	-10...50 °C
Enclosure class	IP54

Motor AC DRIVE SUB 8" 45kW

- Highly efficient 3-phase AC motor
- Frequency: 30...51 Hz
- Premium materials, stainless steel: AISI 304
- No electronics in the motor

Efficiency	max. 84 %
Motor speed	1.690...2.905 rpm
Power factor	0,85
Insulation class	F
Enclosure class	IP68
Submersion	max. 150 m

Pump End PE C-SJ75-12

- Non-return valve
- Premium materials, stainless steel: AISI 304
- Centrifugal pump

Efficiency	max. 78 %
------------	-----------

Pump Unit PUK2-60 C-SJ75-12 (Motor, Pump End)

Borehole diameter	min. 8,0 in
Water temperature	max. 30 °C****

Standards



2006/42/EC, 2004/108/EC, 2006/95/EC

IEC/EN 61702:1995, IEC/EN 62253 Ed.1

The logos shown reflect the approvals that have been granted for this product family. Products are ordered and supplied with the approvals specific to the market requirements.

**Vmp: MPP-voltage under Standard Test Conditions (STC): 1000 W/m² solar irradiance, 25 °C cell temperature

****Special solutions available for >30 °C, please consult your distributor



PSk2-60 C-SJ75-12

Solar Submersible Pump System for 8" wells

Pump Chart

$V_{mp}^* > 575 \text{ V}$

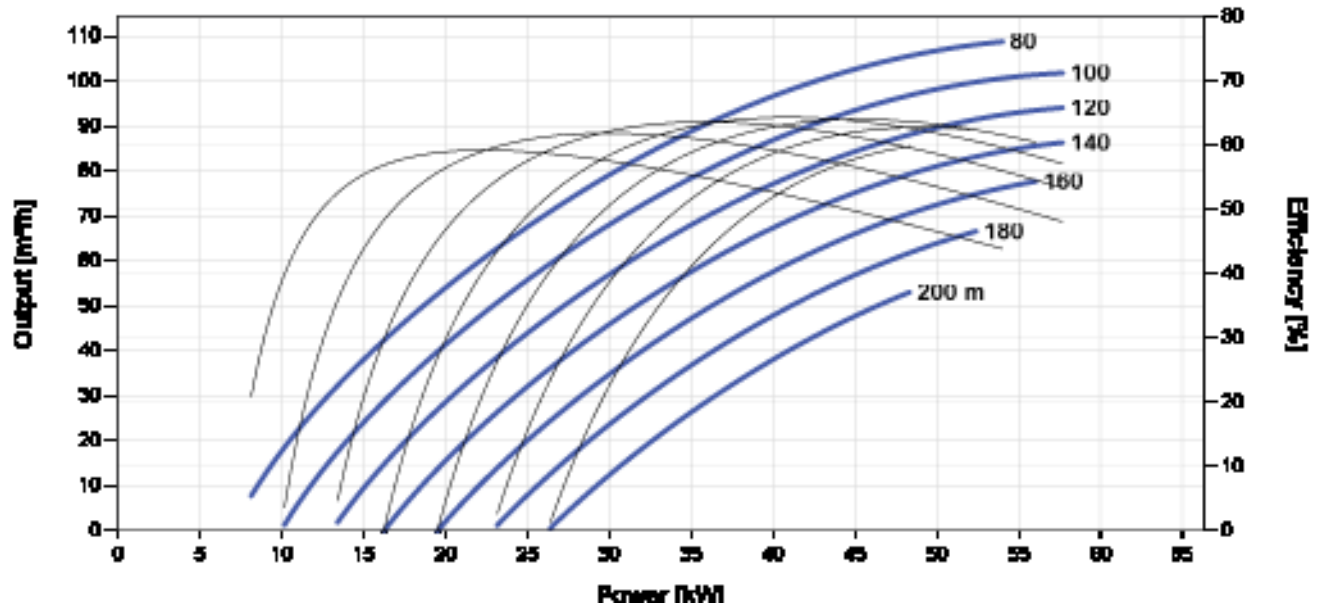

Dimensions and Weights

Controller

H = 859 mm
H1 = 800 mm
H2 = 350 mm
W1 = 610 mm
W2 = 576 mm
D = 10 mm
D1 = 402 mm

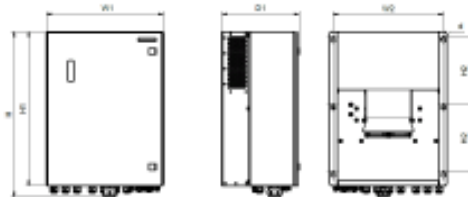

Pump Unit

A = 3.271 mm
B = 1.380 mm
C = 1.891 mm
D = 196 mm
E = 197 mm
S = 5 in

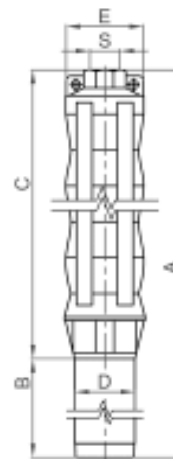

	Net weight
Controller	60 kg
Pump Unit	222 kg
Motor	160 kg
Pump End	62 kg

* V_{mp} : MPP-voltage under Standard Test Conditions (STC): 1000 W/m² solar irradiance, 25 °C cell temperature

